

REVISION HISTORY

ZONE	REV	DESCRIPTION	DATE	APPROVED
	0		12/1/2019	

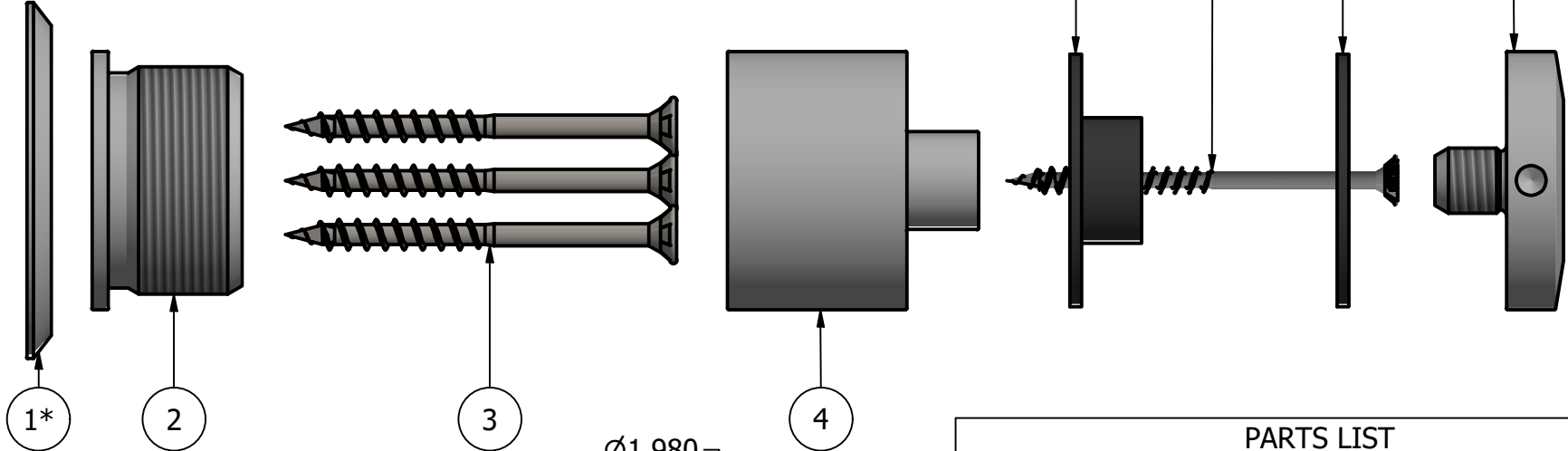

\* OPTIONAL PART FOR COVERING RECESSED DRYWALL

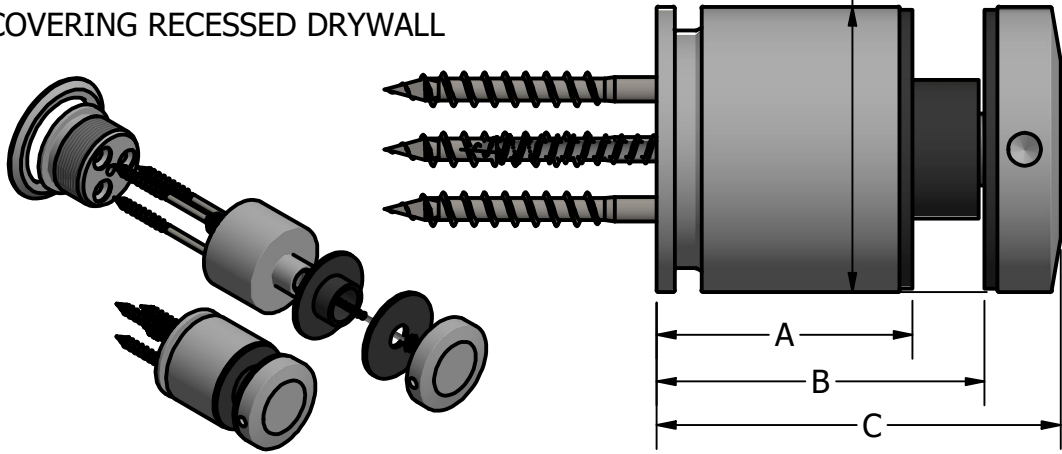

PARTS LIST

ITEM	QTY	PART NUMBER	DESCRIPTION
1*	1	439575	2in Standoff Pin Drywall Skirt
2	1	439576	Universal 2in Aluminum Standoff Pin Base
3	3	439458	#14 X 3 FHCS
4	1	439577	Universal 2in Aluminum Standoff Pin Cover
5	1	451564	Combined Gasket .78ID x 1.94OD x .090THK
6	1	439574	#10 X 3 FHCS
7	1	451565	Gasket .78ID x 1.94OD x .090THK
8	1	439457	2in Standoff Pin End Cap

RECOMMENDED ADJUSTABILITY

DIM	MIN	MAX
A	1.59	1.97
B	2.09	2.47
C	2.62	2.99



PART #: 440853

PART NAME: Glass - Universal 2in Aluminum Standoff Pin



DRAWN BY: RWM

DATE: 1/15/2021

STATUS: WorkInProgress

TOLERANCES  
 .X = ± .030  
 .XX = ± .015  
 .XXX = ± .005

CYCLE TIME:

MATERIAL: Body 6061-T6511 Aluminum

SIZE: A SCALE: .25

REV: